

### (A) FITTING INTO UN-PLASTERED PLASTER BOARD

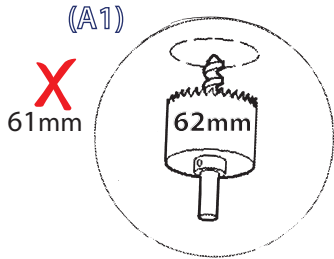

**X** 61mm **X** 63mm

Cut a **Neat Hole** using a normal 62mmØ hole cutter.  
(Note: If use the Flairlight rebate hole cutter, **DO NOT** cut a rebate)

Ensure the hole is **Straight**

**NOTE** - The ceiling housings are **Very Difficult to Remove**

once fitted therefore **before fitting the permanent housings** check the holes using a 'Test Housing' (i.e. one without fixing springs)

Check housings **Protrude**

Fit the permanent housing(s) **ensure they are Level** and the 'plaster up to lip' is **Protruding**.

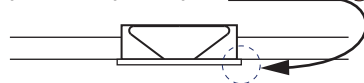

### (B) RETRO-FIT INTO FINISHED PLASTERBOARD

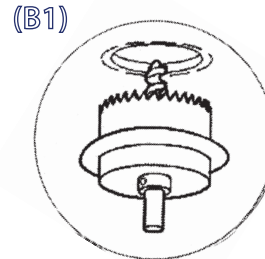

Cut a **Neat Hole + Rebate** using a special rebate hole cutter (Flairlight Part No. 40402.00).

Ensure the hole is **Straight** and the rebate is **Even** and **Level**

**NOTE** - The ceiling housings are **Very Difficult to Remove**

once fitted therefore **before fitting the permanent housings** check the holes and rebates using a 'Test Housing' (i.e. one without fixing springs)

Check the housings are **Level** and **Flush** with the ceiling  
Fit the permanent housing(s) **ensure they are Level and Flush**.

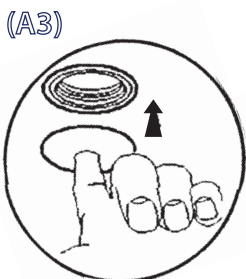
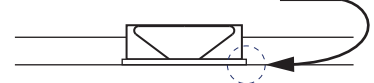

Fit the 'Plastering' cardboard disk into the housing.

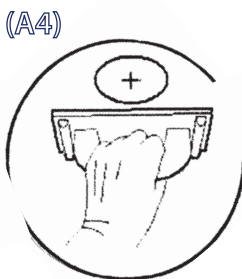

Plaster the ceiling level with the housings' lip.

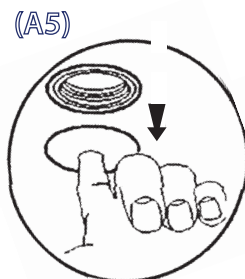

Carefully remove the disk before the plaster dries.

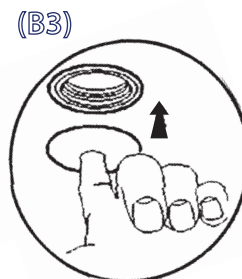

Fit the 'Plastering' cardboard disk into the housing.

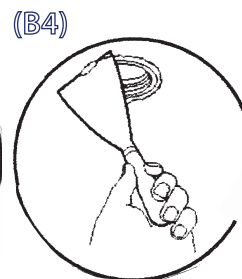

Fill around housing. Carefully remove the disk before filler dries.

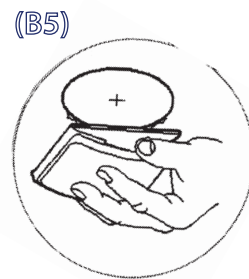

If necessary lightly sand the filler when dry.

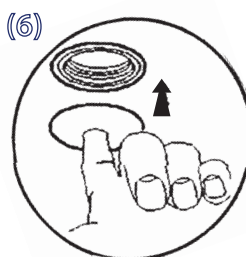

Fit the 'Painting' cardboard disk into the housing.

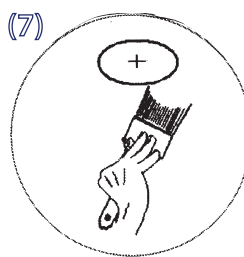

Decorate Ceiling Carefully remove cardboard disk before paint dries.

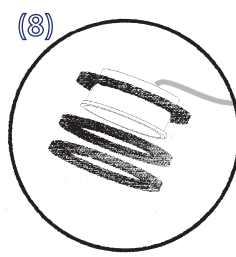

Fit Magnetic Rings onto Light Engine  
Note: 3 Rings required with at least 1 ring behind.

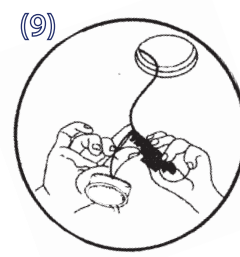

Connect LED Driver or Light Engine to 230V lighting circuit then fit into the ceiling housing.

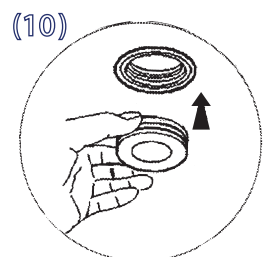

Fit Bezel  
Ensure IP65 Downlights are fitted with a Bezel which has a Glass Lens

